

Access Ladder

VDR-B

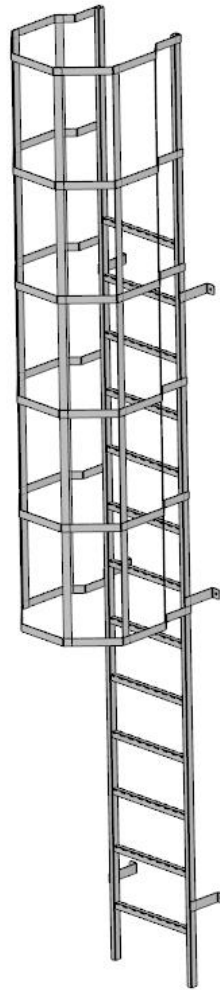

DESCRIPTION:

Access ladders are mounted to the walls of buildings and to steel structures to provide access to higher levels. Made in accordance with DIN 14094-41, DIN 18799-1. Available in various sizes, materials and with a wide range of additional options.

MATERIALS:

Welded construction made of stainless steel, e.g. AISI 304/304L - 1.4301/1.4307, acid-resistant AISI 316/316L - 1.4401/1.4404, galvanized or painted carbon steel, or any other, depending on customer requirements and mounting conditions.

MOUNTING:

Ladders mounted to the wall using adhesive or expansion anchors, screwed to steel structures using screws or welded.

ADDITIONAL OPTIONS:

A number of additional options are available, such as a self-closing gate, adjustable offset from the wall, anti-slip steps or safety rail, etc.

DOCUMENTATION:

Standard documentation delivered with the delivery includes: the national declaration of performance, technical and operational documentation along with the operating and assembly instructions. On request, we provide material certificates, welding documents and other according to the customer's needs.

STANDARD DIMENSIONS:

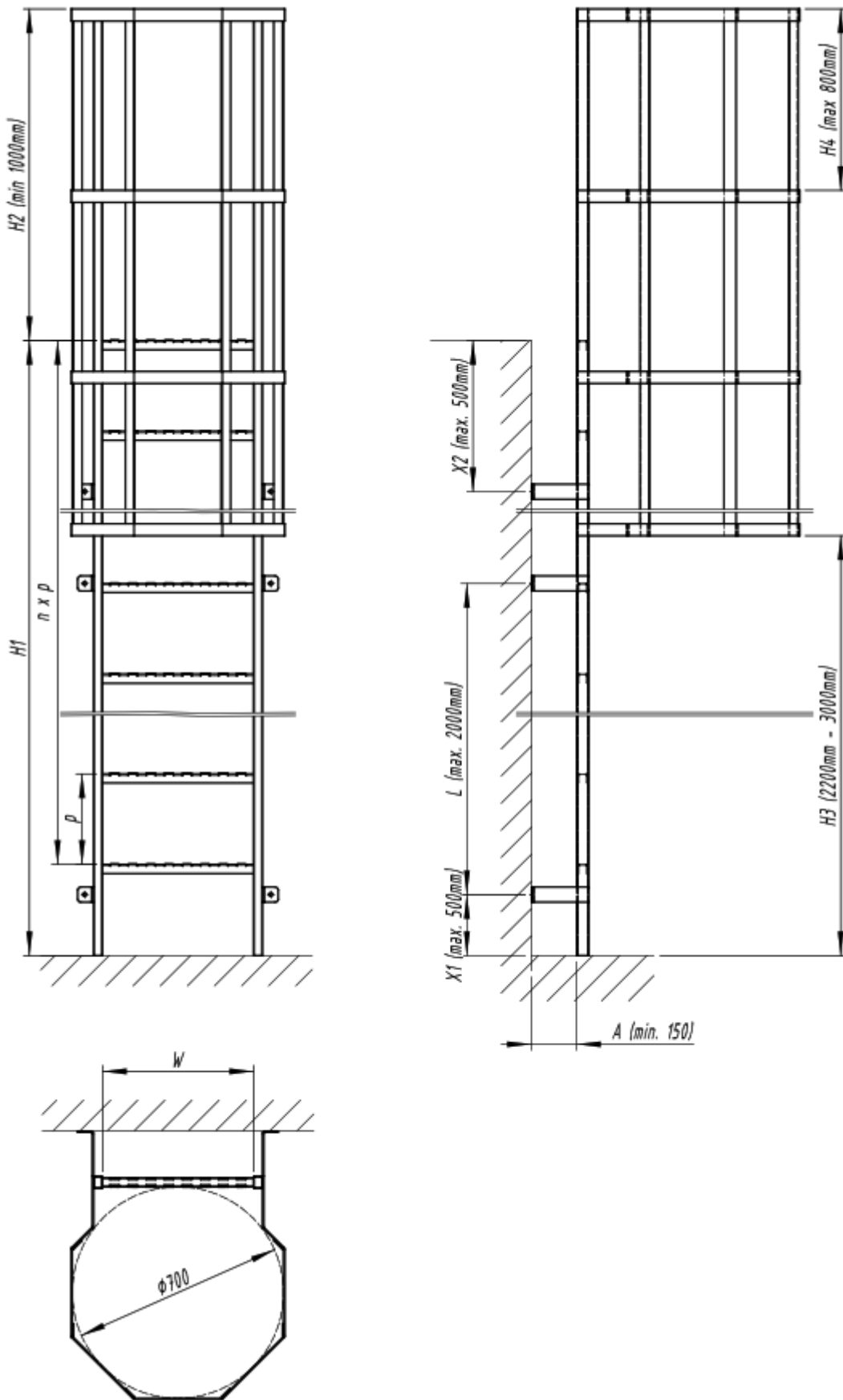

STANDARD DIMENSIONS: $W=500\text{mm}$, $P=300\text{mm}$, $A=150\text{mm}$, $H2=1100\text{mm}$. When other dimensions are needed, please specify in the order. It is required to specify the length of the ladder H .